

PACKING LIST

Name	Quantity	Notes
Main Machine	1	
Power Cord	1	
Lamp Shade	1	
Carrying Case	1	
User Manual	1	
The remote control	1	

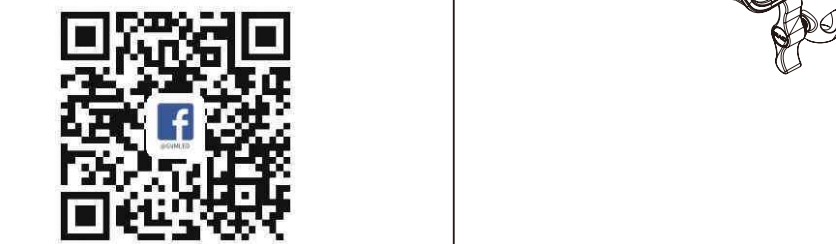

GVM Official website Facebook

Web: www.gvmed.com
B&H Email: bh@gvmed.com
GVM Email: support@gvmed.com
Amazon Email: amazonsupport@gvmed.com
Warehouse Add: 4301 N Delaware ave, unit D, PHILADELPHIA, PA19137, USA

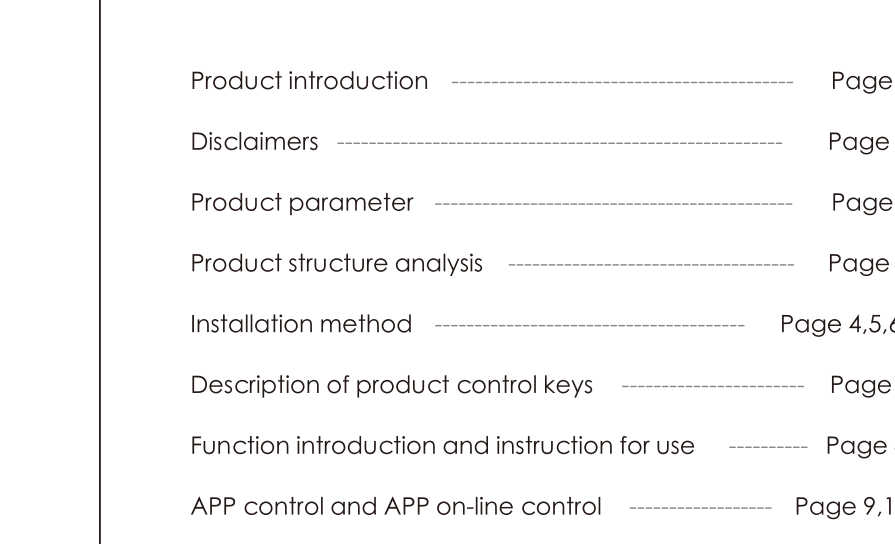

C O N T E N T S

Product introduction	Page 1
Disclaimers	Page 1
Product parameter	Page 2
Product structure analysis	Page 3
Installation method	Page 4,5,6
Description of product control keys	Page 7
Function introduction and instruction for use	Page 8
APP control and APP on-line control	Page 9,10
Precautions	Page 11
Simple faults and troubleshooting	Page 12
Use and preservation	Page 12
Packing list	Page 13

PRODUCT INTRODUCTION

Welcome to "GVM-S300S". This product is specially designed for senior photography enthusiasts. The product is suitable for live / outdoor / studio photography, and also for YouTube video shooting.

The main features of the product are:

- ① It has the character of stepless adjusting and it possesses 1 COB lamp bead, which contribute to the recovering and enriching of object colors; it provides you with natural and vivid shooting effect.
- ② The product has DMX interface, it can be controlled by DMX console.
- ③ The product has LCD display and stable system, supports 360 rotation, and can effectively control light. Equipped with a standard cover, it can avoid extra light, make the light more concentrated, and customize the control of supplementary light, so that you can easily shoot the desired results at will.

We firmly believe that the correct use of this product will definitely help your shooting work. Before using the product, we strongly recommend that you carefully read the following user guide.

DISCLAIMERS

1. Before using this product, please read the instructions carefully and make sure use the product correctly. If you don't obey the instructions and warnings, you maybe cause harm to yourself and the people around, or even damage the product and other things around.
2. Once you use this product, you are deemed to have read the disclaimer and warning carefully, understand and acknowledge all the terms and contents of this statement, and promise to take full responsibility for the use of this product and possible consequences.

PRODUCT PARAMETER

- ◆ Brand : GVM
- ◆ Product Model : GVM-S300S
- ◆ Product Type : Photography Fill Light
- ◆ Product Name : Photography lights
- ◆ Features / Features: Joint control, High color rendering index light beads, DMX Console interface, Remote control

- ◆ Color Rendering Index : ≥97
- ◆ Color Temperature : 5600K
- ◆ Brightness: Bare light : 55000lux/0.5m, 16000lux/1m
Plus standard cover : 90000lux/0.5m, 37300lux/1m

- ◆ Light Adjustment Method : Stepless adjustment
- ◆ Lamp Beads Quantity : COB×1
- ◆ Light angle of lamp bead : 120°
- ◆ Product Weight : 4KG
- ◆ Power : 300W
- ◆ Product Size(mm) : 440*230*202
- ◆ Cooling : Radiator cooling
- ◆ Product Material : Aluminum alloy
- ◆ Voltage : DC60V
- ◆ Power Supply : DC60V/5A(Fixed on the lamp body)
- ◆ Power Supply Mode : AC input
- ◆ Commodity Origin : Huizhou.China

PRODUCT STRUCTURE ICON

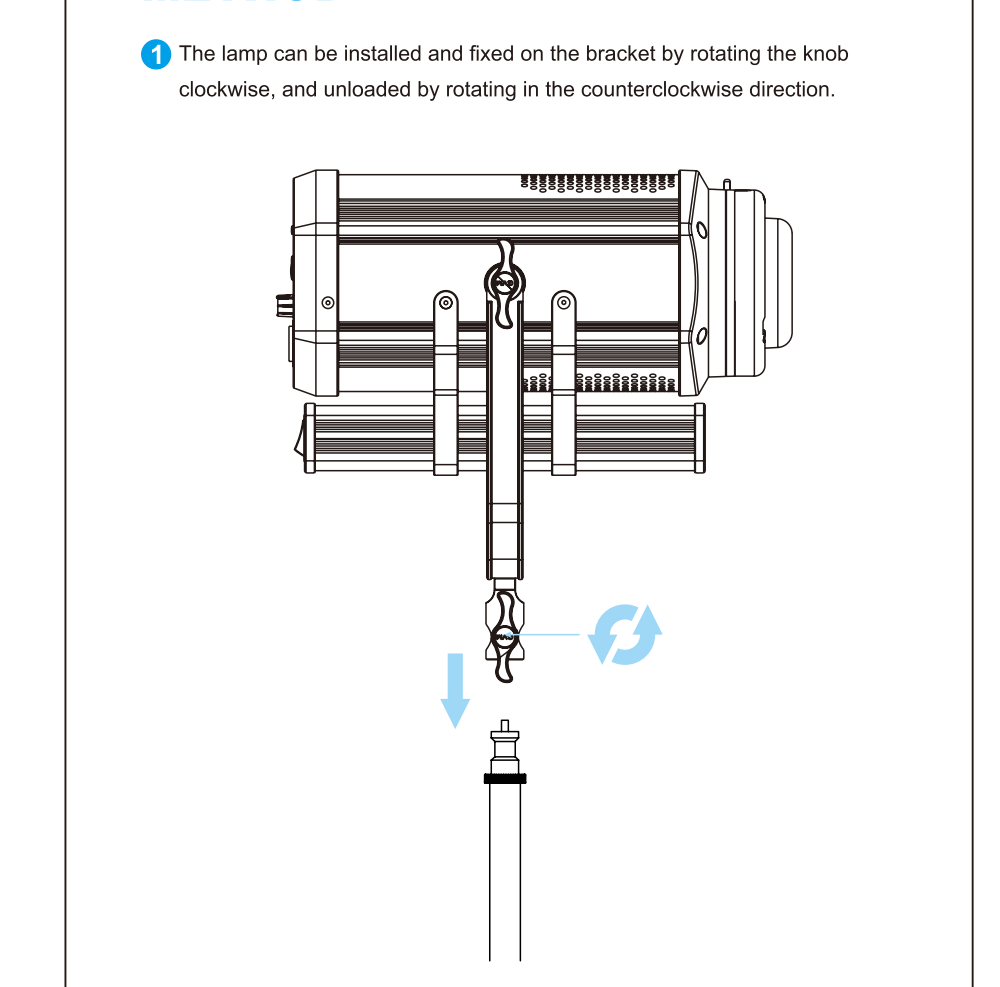

INSTALLATION METHOD

- ① The lamp can be installed and fixed on the bracket by rotating the knob clockwise, and unloaded by rotating in the counterclockwise direction.

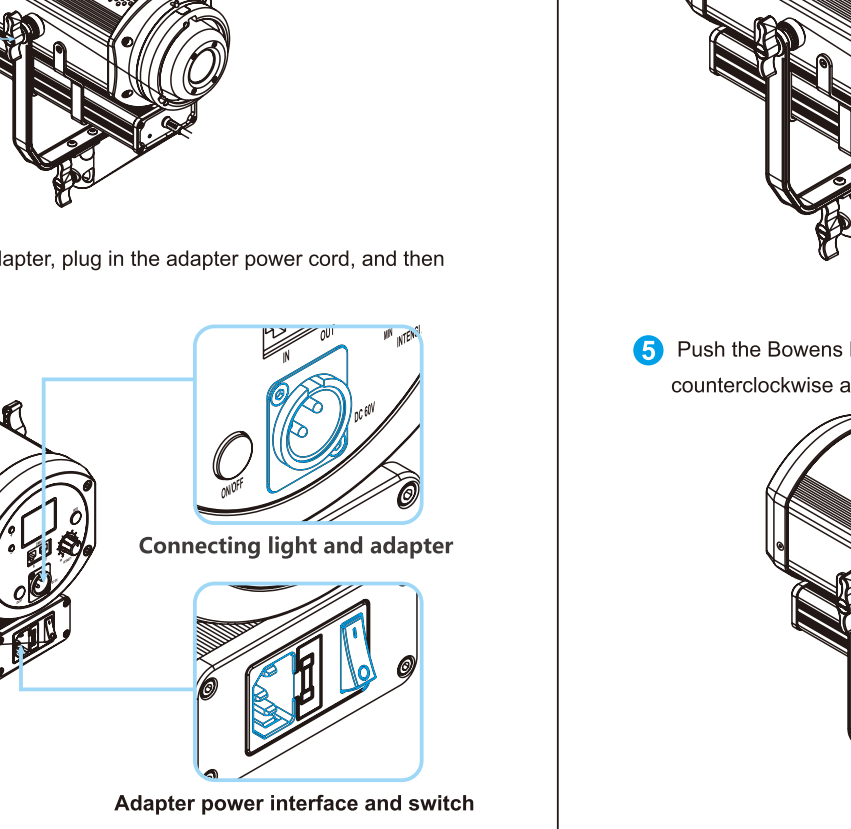

INSTALLATION METHOD

- ② Loosen the adjustment knobs on both sides of the U-bracket, adjust the angle of the panel you need, and then tighten the adjustment knobs on both sides of the U-bracket.

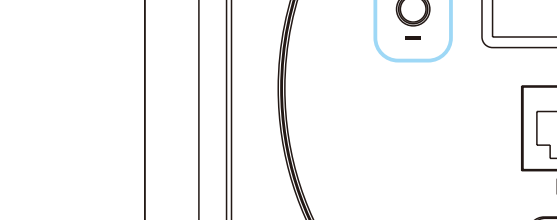

- ③ Connect the lamp and adapter, plug in the adapter power cord, and then turn on the power switch.

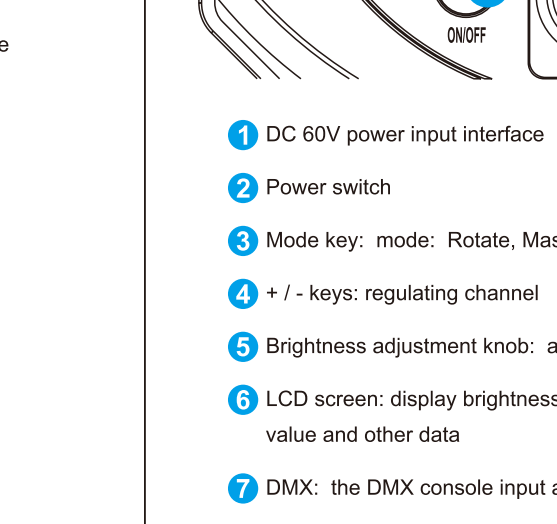

INSTALLATION METHOD

- ④ Insert the Bowens Mount of the lampshade into the Bowens Mount of the lamp, and then turn it gently clockwise.

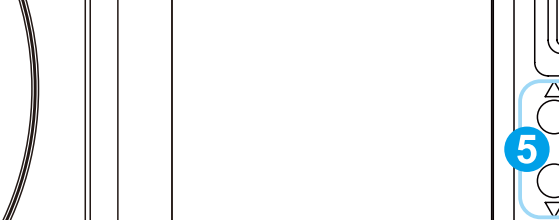

- ⑤ Push the Bowens Mount to the upper right, and rotate the lampshade counterclockwise at the same time to disassemble the lampshade.

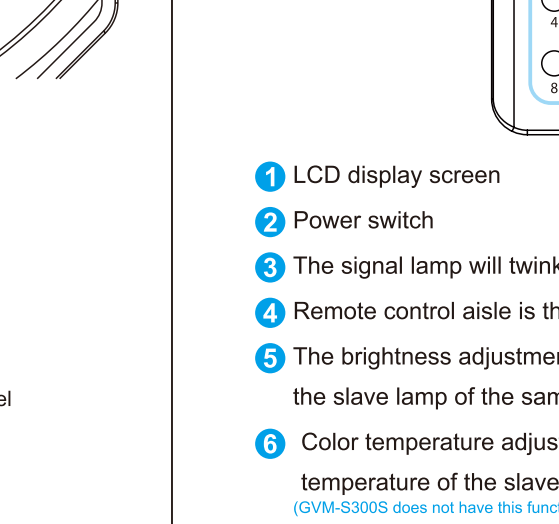

DESCRIPTION OF PRODUCT CONTROL KEYS

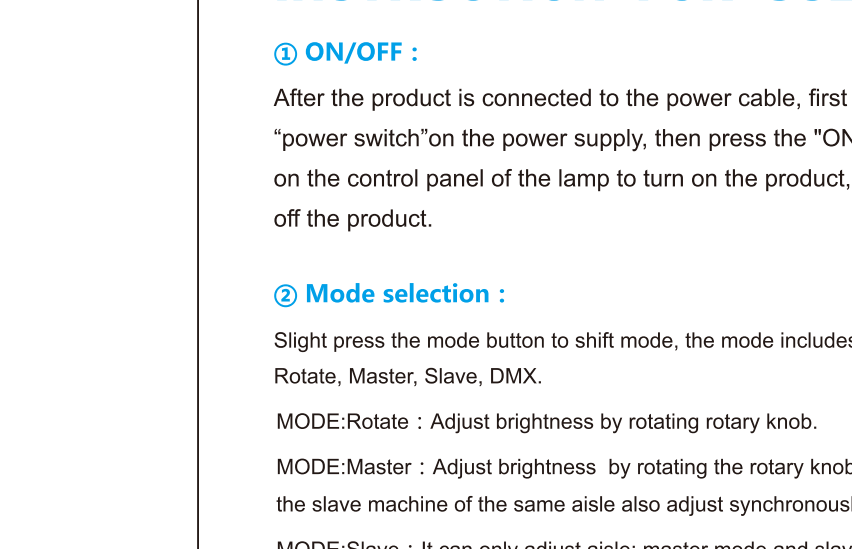

- ① DC 60V power input interface
- ② Power switch
- ③ Mode key: mode: Rotate, Master, Slave, DMX.
- ④ + / - keys: regulating channel
- ⑤ Brightness adjustment knob: adjust brightness
- ⑥ LCD screen: display brightness, color temperature, mode, channel value and other data
- ⑦ DMX: the DMX console input and output port.

DESCRIPTION OF REMOTE CONTROL

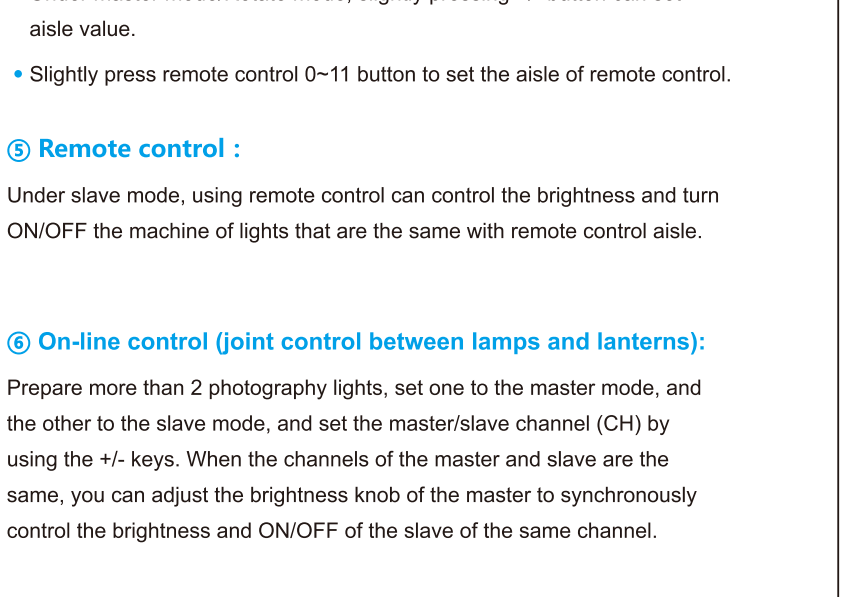

- ① LCD display screen
- ② Power switch
- ③ The signal lamp will twinkle when pressing down the button.
- ④ Remote control aisle is the aisle that sets the remote control.
- ⑤ The brightness adjustment button, can adjust the brightness of the slave lamp of the same channel.
- ⑥ Color temperature adjustment button, can adjust the color temperature of the slave lamp of the same channel.
(GVM-S300S does not have this function)

FUNCTION INSTRUCTION & INSTRUCTION FOR USE

① ON/OFF :

After the product is connected to the power cable, first turn on the "power switch" on the power supply, then press the "ON / OFF" button on the control panel of the lamp to turn on the product, otherwise turn off the product.

② Mode selection :

Slight press the mode button to shift mode, the mode includes:
MODE:Rotate : Adjust brightness by rotating rotary knob.
MODE:Master : Adjust brightness by rotating the rotary knob and make the slave machine of the same aisle also adjust synchronously.
MODE:Slave : It can only adjust aisle; master mode and slave mode can only be synchronously controlled by master mode under the condition that they are under the same aisle.

③ Adjust brightness (BRG): range 10%~100%

- Under master mode/Rotate mode, rotating brightness adjusting rotary knob can adjust brightness.
- Under slave mode, can adjust brightness of lights that are same with remote control aisle by using remote control.

PRECAUTIONS

--- Light ---

- ① The product is not waterproof, please use it in rainproof environment.
- ② The product is not anti-corrosion, therefore do not let the product touch any corrosive liquid.
- ③ When using the product, make sure the product is put firmly and prevent from falling and damage.
- ④ If the product will not be used for a long time, please switch off the power to reduce energy loss.

--- The remote control ---

- ① Pay attention to the polarity property of storage battery when installing storage battery.
- ② Do not mix-use old battery and new battery.
- ③ Please take out the battery if you will not use the remote control a for long time.
- ④ Do not put any liquid on the remote control or let it flow into the remote control; liquids will cause electric leakage or circuit damage.
- ⑤ Do not put the remote control under the sun for a long time, it will make the color of the screen fade.
- ⑥ Handle lightly.

SIMPLE FAULTS AND TROUBLESHOOTING

Phenomenon	Check the product	Troubleshooting
The boot light is off	1. Whether the switch above the power supply is turned on. 2. Whether the connection plug between the power supply and the lamp is in place.	1.Turn on the power switch above the power supply. 2. Insert the connection plug.
The knob of lightness is out of control	Check if the "Mode" key is switched to the "Slave" mode. In the slave mode, the product brightness is controlled.	Press the "mode" button for once, switch the mode from slave mode to master mode

USE AND PRESERVATION

Do not put the product in a highly humid, strong electromagnetic field, direct sunlight, high-temperature environment. If not use the product for a long time, disconnect the power.

Clean : Before clean, disconnect the power plug. And use wet cloth rather than any detergent or soluble liquid, avoiding damaging the surface layer.

Power : Make sure the power is in the demanded range, not too high or too low.

Repairing : If there is fault or performance degradation, do not unpack the shell by yourself, avoiding damage the machine and lose the right of maintenance. When there is a fault, do not hesitate to contact us, and we will do our best to deal with the problem.

Accessories : Please use the accessories provided by manufacturer and approved ones, in order to maximize the performance.

Guarantee : Do does not modify the product, or you will lose the right of maintenance.